

CAUTION: INCORRECT MANIFOLDING WILL CAUSE SEVERE LOCAL STRESS AROUND PORT AND MAY RESULT IN LEAKS AND PREMATURE FAILURE; TAKE EVERY PRECAUTION LISTED ON PAGE 02, SEE INSTALLATION INSTRUCTIONS FOR FURTHER DETAILS

DWG REF	QTY	PART NUMBER	DESCRIPTION	MATERIAL
SHELL				
1	1	418094	SHELL	Filament Wound Epoxy/Glass composites - Head locking grooves integrally wound in place.
HEAD				
2	2	50420	End plug	Engineering Thermoplastic.
3	2	50440	Bearing Ring	Nickel-plated Alloy Steel
4	2	196266	Head Seal	Ethylene Propylene - O - Ring
5	2	196431	Adapter Seal	Ethylene Propylene - O - Ring
HEAD INTERLOCK				
6	2	45260	Retaining Ring	SA-479 SS316.
VESSEL SUPPORT				
7	2*	45058	Saddle	Engineering Thermoplastic.
8	2*	47459	Strap Assembly	304 Stainless Steel-PVC Cushion.
9	4**	97821	Strap screw	5/16-18 UNC, 1.5" L, 18-8 Stainless Steel.
ELEMENT INTERFACE				
10	2	A/R	Adapter	Engineering Thermoplastic.
11	A/R	A/R	PWT Seal	Ethylene Propylene - O - Ring

\*3 each & \*\*6 nos. furnished with length code 4,5 & 6.

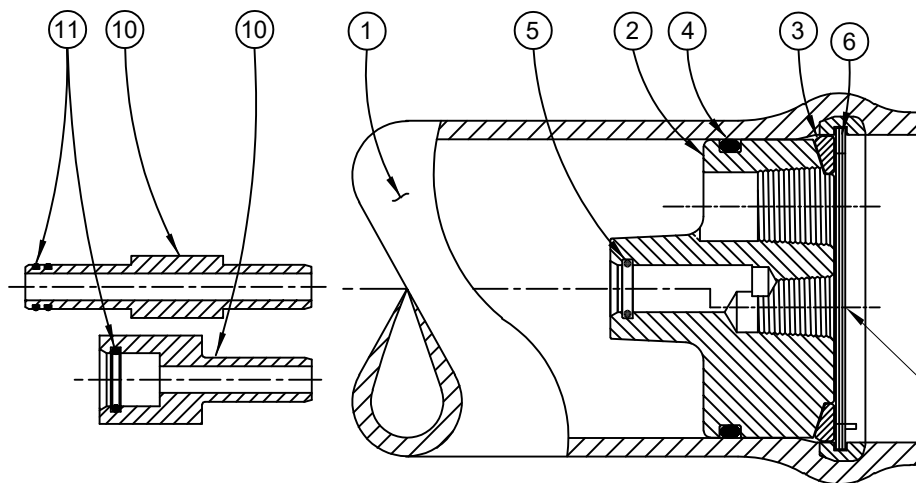

SECTION THROUGH END CLOSURE

Dash Length	L IN(MM)	S IN(MM)	Approx Weight LB(KG)**
-1	49.90 (1267)	28X1 (711)	14 (6)
-2	89.90 (2283)	56X1 (1422)	22 (10)
-3	129.90 (3299)	80X1 (2032)	31 (14)
-4	169.90 (4315)	64X2 (1626)	39 (18)
-5	209.90 (5331)	78X2 (1981)	48 (22)
-6	249.90 (6347)	92X2 (2337)	56 (25)

GENERAL NOTES:

1. DIMENSION IN INCHES (MM APPROX.).
2. SHELL EXTERIOR COATED WITH WHITE RAL 9003, HIGH GLOSS POLYURETHANE PAINT.
3. NOT TO BE USED FOR CONSTRUCTION UNLESS CERTIFIED BY PENTAIR.

\*\* WEIGHTS GIVEN IN THE TABLE ARE FOR HIGHEST CONFIGURATION AND WILL VARY WITH CHANGE IN CONFIGURATION.

THIS DOCUMENT AND THE INFORMATION CONTAINED HEREIN, ARE THE CONFIDENTIAL AND PROPRIETARY INFORMATION OF PENTAIR WATER INDIA PVT. LTD. PENTAIR WATER INDIA PVT. LTD. IS THE SOLE OWNER OF THE INFORMATION AND PROCESSES DEFINED HEREIN. THIS DOCUMENT, AND THE INFORMATION CONTAINED, MAY NOT BE DISCLOSED, REPRODUCED, DUPLICATED, USED, SOLD, PUBLISHED, COMMUNICATED OR OTHERWISE DISTRIBUTED, IN WHOLE OR IN PART, FOR ANY PURPOSE WITHOUT THE EXPRESS WRITTEN CONSENT OF PENTAIR WATER INDIA PVT. LTD. THIS DOCUMENT AND ANY COPIES, IN ALL APPLICABLE FORMATS, SHALL BE RETURNED TO PENTAIR WATER INDIA PVT. LTD. UPON REQUEST.

ALL INDICATED PENTAIR TRADEMARKS AND LOGOS ARE PROPERTY OF PENTAIR. THIRD PARTY REGISTERED AND UNREGISTERED TRADEMARKS AND LOGOS ARE PROPERTY OF THEIR RESPECTIVE OWNERS. BECAUSE WE ARE CONTINUOUSLY IMPROVING OUR PRODUCTS AND SERVICES, PENTAIR RESERVES THE RIGHT TO CHANGE SPECIFICATIONS WITHOUT PRIOR NOTICE. PENTAIR IS AN EQUAL OPPORTUNITY EMPLOYER.

© 2021 Pentair. All Rights Reserved.

**PENTAIR**  
**CODELINE**

VERNA, GOA  
INDIA

DRAWN BY:	AXA	DRAWING DESCRIPTION:	DRAWING NO.:	REV.:
DATE:	20FEB17	MODEL - 40E60 MEMBRANE HOUSING	518017	K
CHECKED BY:	-	CUSTOMER NAME:	VESSEL MODEL:	
DATE:	-	-	40E60	
APPROVED BY:	RM	PROJECT NAME:	TOTAL QTY:	
DATE:	20FEB17	-	-	
ECN NO.:	6801	CUSTOMER P.O.#:	SIZE:	PAGE NO.:
REV. DATE:	29NOV24	-	A3	01 OF 02

RATING:

DESIGN PRESSURE/MAWP.....600 PSI  
(4.14 Mpa)  
MAX. ALLOWABLE TEMP.....120°F  
(49°C)  
MIN. ALLOWABLE TEMP.....20°F  
(-7°C)  
FACTORY TEST PRESSURE.....660 PSIG  
(4.55 MPa)  
BURST PRESSURE.....3600 PSI  
(24.82 MPa)

INTENDED USE:

The Model 40E60 Fiberglass RO/UF Pressure Vessel is designed for continuous, long term use as housing for reverse osmosis and ultrafiltration elements in typical industrial water treatment systems at pressures up to 600 psi. Any make of four-inch nominal diameter spiral-wound element is easily accommodated. The appropriate interfacing hardware for the element specified is furnished with the vessel.

The Model 40E60 must be installed, operated and maintained in accordance with the listed precautions and good industrial practice to assure safe operation over a long service life.

The high performance reinforced plastic shell must be allowed to expand under pressure; undue restraint at support points or piping connections can cause leaks to develop in the shell. The end closures, incorporating close-fitting, interlocking metal components, must be kept dry and free of corrosion; deterioration can lead to catastrophic mechanical failure of the heads.

Pentair will assist the purchaser in determining the suitability of this standard vessel for their specific operating conditions. The final determination however, including evaluation of the standard material of construction for compatibility with the specific corrosive environment, shall be the responsibility of the purchaser. Alternate materials with enhanced corrosion resistance are available on special order.

Specifications are subject to change without notice.

PRECAUTIONS:

DO...read, understand and follow all instructions; failure to take every precaution will void warranty and may result in vessel failure  
DO...mount the shell on horizontal members at span “S” using complaint vessel supports furnished; tighten hold down straps just snug  
DO...provide flexibility in, and support for piping manifolds so that vessel can grow in length under pressure without undue restraint; provide additional flexible joints in large pipes leading to manifold header  
DO...provide overpressure protection for vessel set at not more than 105% of design pressure  
DO...inspect end closures regularly; replace components that have deteriorated and correct causes of corrosion

DO NOT...work on any component until first verifying that pressure is relieved from vessel  
DO NOT... make rigid piping connections to ports or clamp vessel in any way that resists growth of fiberglass shell under pressure; ΔDIA = 0.02 in. (0.5mm) and ΔL = 0.2 in. (5mm) for a length code –6 vessel  
DO NOT... hang piping manifolds from ports or use vessel in any way to support other components.  
DO NOT... operate vessel at pressures and temperatures in excess of its rating  
DO NOT... operate vessel without permeate ports internally connected with a complete set of elements and interconnecting hardware.  
DO NOT... operate vessel with permeate pressure in excess of 125 psi at 120°F (0.86 MPa @ 49°C)  
DO NOT... overtighten the connection to the permeate port (hand-tighten plus one-quarter turn, check for leaks)  
DO NOT... tolerate leaks or allow end closures to be routinely wetted in any way  
DO NOT... pressurize vessel until double-checking to verify that the retaining ring is completely inside the groove  
DO NOT... operate outside the pH range 3-11.  
DO NOT...operate outside the pH range 2-12 for cleaning.  
DO NOT...exceed 43.5 hours in a year for cleaning with above mentioned pH range.

CAUTION:

EYE PROTECTION SHOULD BE WORN WHEN REMOVING OR INSTALLING RETAINING RINGS. KEEP FINGERS CLEAR FROM RETAINING RING WHILE INSTALLING LAST OF TWO TURNS. RING MAY SNAP INTO POSITION POSSIBLY PINCHING FINGERS.

ORDERING:

Using the chart below, please check the features you require and fax them with your purchase order to our customer service department for expedited processing.  
For optional materials and/or features not listed below, please consult factory for pricing and availability.

Please note that we require your membrane brand and model number when ordering. If this information is not initially available, you may provide it at a later date by checking the appropriate box below.

VESSEL LENGTH CODE – please check one

MODEL 40E60 ☐ -1 ☐ -2 ☐ -3 ☐ -4 ☐ -5 ☐ -6

MEMBRANE BRAND AND MODEL – please check one and fill in information

☐ Please supply adapters for the following membrane brand and specific model  
Brand\_\_\_\_\_ Model\_\_\_\_\_  
  
☐ Membrane brand and model information is not available, but will be supplied to Pentair on or before the following date \_\_\_\_/\_\_\_\_\_/\_\_\_\_\_

CERTIFICATION – please check one

☐ CE Marked – MODULE-D1, CATEGORY-2 (Not applicable for -1 vessel)  
☐ Certified by Pentair

EXTERIOR FINISH

☐ Standard – White high-gloss RAL 9003 polyurethane coating over sanded surface.  
☐ Optional – Optional colours are available for 50 or more vessels per order. Call factory for pricing details.

Serial number	Opposite
End	End

☐

☐

**PERMEATE PORT CONFIGURATION**  
Standard – ½” NPT Female

☐

☐

**FEED PORT CONFIGURATION**  
Standard – ¾” NPT Female  
Optional – ½” NPT Female

☐

☐

For complete information on proper use of the vessel  
Please refer to 40E60 USER’S GUIDE - 526004

NOTE

Spiral Retaining Ring Removal Tool (50303)  
Recommended to open and close vessel

THIS DOCUMENT AND THE INFORMATION CONTAINED HEREIN, ARE THE CONFIDENTIAL AND PROPRIETARY INFORMATION OF PENTAIR INDIA PVT. LTD. PENTAIR INDIA PVT. LTD. IS THE SOLE OWNER OF THE INFORMATION AND PROCESSES DEFINED HEREIN. THIS DOCUMENT, AND THE INFORMATION CONTAINED, MAY NOT BE DISCLOSED, REPRODUCED, DUPLICATED, USED, SOLD, PUBLISHED, COMMUNICATED OR OTHERWISE DISTRIBUTED, IN WHOLE OR IN PART, FOR ANY PURPOSE WITHOUT THE EXPRESS WRITTEN CONSENT OF PENTAIR INDIA PVT. LTD. THIS DOCUMENT AND ANY COPIES, IN ALL APPLICABLE FORMATS, SHALL BE RETURNED TO PENTAIR INDIA PVT. LTD. UPON REQUEST.

ALL INDICATED PENTAIR TRADEMARKS AND LOGOS ARE PROPERTY OF PENTAIR. THIRD PARTY REGISTERED AND UNREGISTERED TRADEMARKS AND LOGOS ARE PROPERTY OF THEIR RESPECTIVE OWNERS. BECAUSE WE ARE CONTINUOUSLY IMPROVING OUR PRODUCTS AND SERVICES, PENTAIR RESERVES THE RIGHT TO CHANGE SPECIFICATIONS WITHOUT PRIOR NOTICE. PENTAIR IS AN EQUAL OPPORTUNITY EMPLOYER.

© 2021 Pentair. All Rights Reserved.

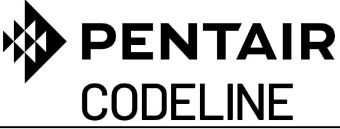

VERNA, GOA  
INDIA

DRAWN BY:	AXA	DRAWING DESCRIPTION:	DRAWING NO.:	REV.:
DATE:	20FEB17	MODEL - 40E60 MEMBRANE HOUSING	518017	K
CHECKED BY:	-	CUSTOMER NAME:	VESSEL MODEL:	
DATE:	-	-	40E60	
APPROVED BY:	RM	PROJECT NAME:	TOTAL QTY:	
DATE:	20FEB17	-	-	
ECN NO.:	6801	CUSTOMER P.O.#:	SIZE:	SCALE:
REV. DATE:	29MAY24	-	A3	NONE
				PAGE NO.: 02 OF 02