

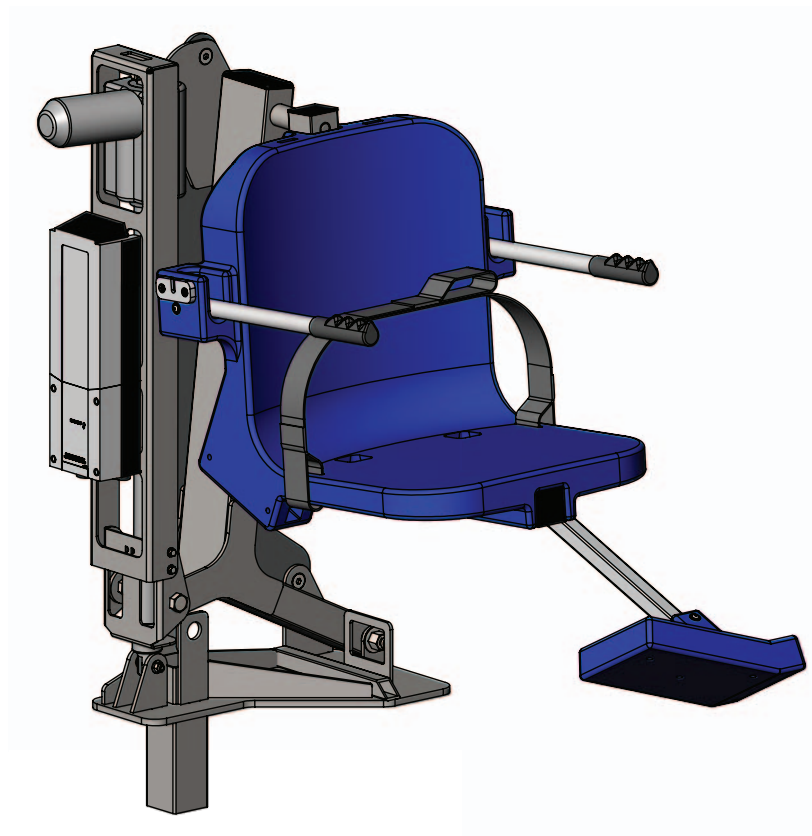

AQUATRAM[®]

SWIMMING POOL ACCESS LIFT



INSTALLATION AND USER'S GUIDE

IMPORTANT SAFETY INSTRUCTIONS
READ AND FOLLOW ALL INSTRUCTIONS
SAVE THESE INSTRUCTIONS

AquaTram Lift

400 LB. [181 kg] MAXIMUM CAPACITY

MANDATORY - LEAVE THIS MANUAL WITH LIFT OWNER

READ CAREFULLY

Check entire box and inside all packing materials for parts. Before beginning assembly, read the instructions and identify parts using the figures and parts listed in this document.

It is critical all parts be carefully inspected by the installer prior to installation to ensure no damage occurred in transit and a damaged part is not used. If any damage occurred in transit, Pentair Commercial Aquatics™ ("Pentair") must be notified within three days of receipt of unit.

Proper installation cannot be overstressed, as an improper installation voids Pentair's warranty and may affect the safety of the user.



WARNING

IMPORTANT SAFETY INSTRUCTIONS

1. READ AND FOLLOW ALL INSTRUCTIONS. LIFT SAFETY CAN ONLY BE ENSURED IF THE LIFT IS INSTALLED AND OPERATED PROPERLY - ACCORDING TO THESE INSTRUCTIONS.
2. WARNING - TO REDUCE RISK OF INJURY, DO NOT PERMIT CHILDREN TO USE OR OPERATE THIS PRODUCT.
3. WARNING - DO NOT PERMIT CHILDREN TO PLAY ON THIS PRODUCT.
4. WARNING - NEVER APPLY DIRECT WATER PRESSURE TO ELECTRONIC COMPONENTS.
5. DO NOT USE THE AQUATRAM FOR WATER DRAFTS OVER 9" (DECK TO WATERLINE).
6. NEVER OPERATE THIS LIFT UNDER LOAD WITH NO WATER (DRY POOL).
7. SAVE A COPY OF THESE INSTRUCTIONS.

WARNING

MAKE SURE THE AREA AROUND THE LIFT IS CLEAR BEFORE OPERATING. NEVER OPERATE THE LIFT WITH ANY PERSON WITHIN THE OPERATING RANGE OF THE LIFT, INCLUDING ON THE DECK OR IN THE WATER. NEVER MOVE THE LIFT DOWN WHILE OVER THE DECK. IF THE LIFT COMES INTO CONTACT WITH THE DECK OR A WALL, RELEASE THE BUTTON IMMEDIATELY OR PRESS THE EMERGENCY STOP BUTTON. DO NOT ALLOW CHILDREN TO OPERATE THE LIFT WITHOUT SUPERVISION.

CHECK ALL NUTS AND BOLTS FOR TIGHTNESS AND FOR WORN PARTS BEFORE EACH USE.

AquaTram Lift

Table of Contents

| PAGE | DESCRIPTION | PAGE | DESCRIPTION |
|------|---------------------------------------|------|---------------------------------|
| 3 | AquaTram Components | 8 | Basic Troubleshooting |
| 4 | ADA Installation Guidelines | 9 | Proper Care of Pool & Spa Lifts |
| 5 | Anchor Installation: Retro-Fit | 10 | AquaTram Parts List |
| 6 | Anchor Installation: New Construction | 11 | Seat Parts List |
| 7 | AquaTram Lift Assembly Instructions | 12 | Warranty |

AquaTram Components

1. AQUATRAM LIFT MAIN ASSEMBLY
2. 24V LINAK BATTERY
3. LINAK BATTERY CHARGER
4. VITO HANDSET
5. SAFETY BELT

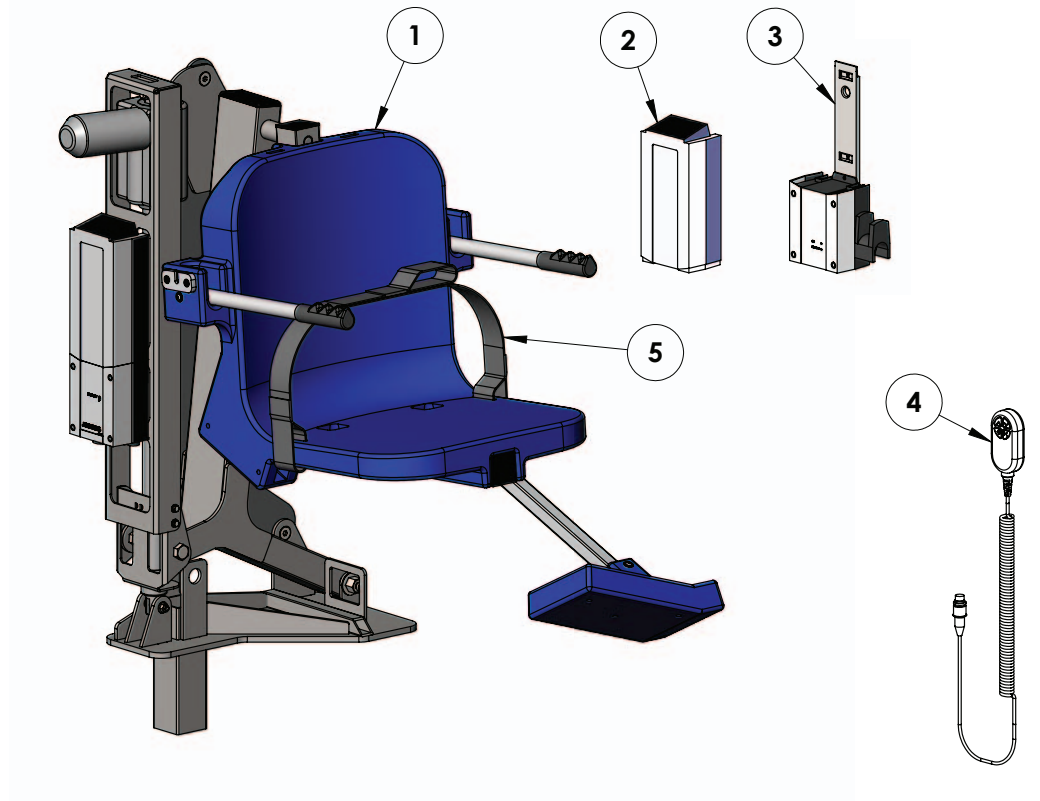

Installation: ADA Guidelines

ADA REQUIREMENTS:

The AquaTram Lift is ADA Compliant.

The installation must meet the following requirements:

- Clear Deck Space Dimensions (see FIGURE 1)
- Lift installed between 18 inches and 23 inches from the pool edge
- Deck slope no greater than 1:48
- The seat must go at least 18 inches into the water. The lift should be installed at a location with 42-48 inches of depth (deck to pool floor)
- Anchor setbacks are based on straight pool/spa walls. Curved pool/spa walls will effect the anchor setback.

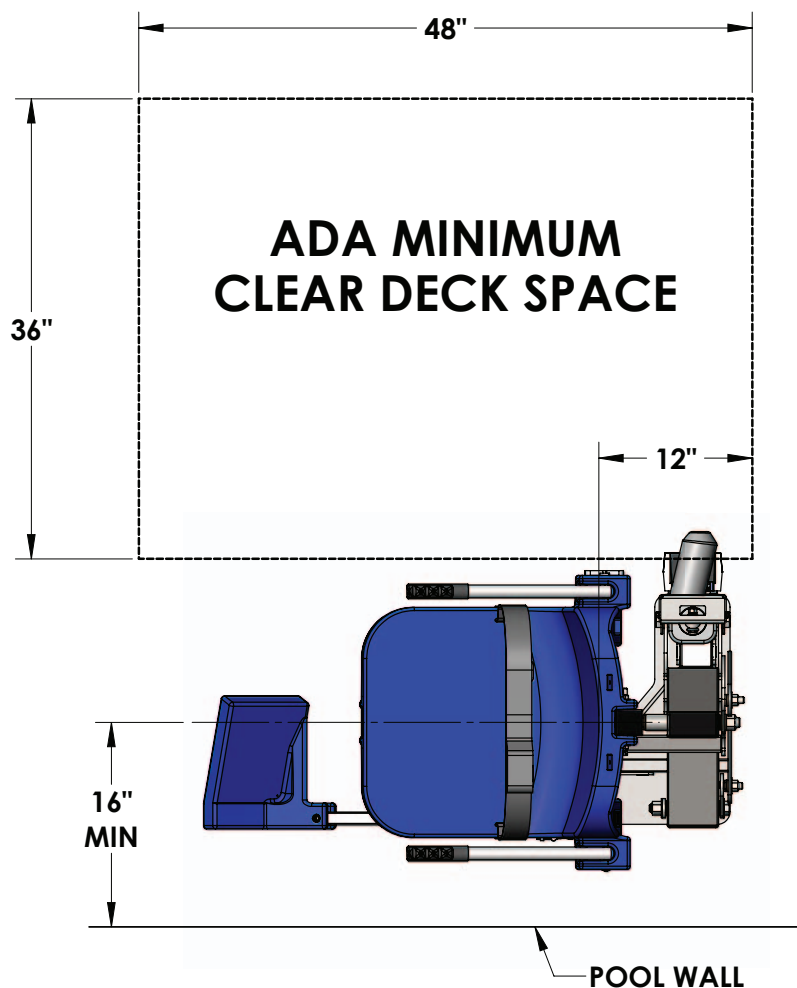

FIGURE 1

Anchor Installation: Retro-Fit

You Will Need:

- Concrete saw & diamond blade (or)
- Core drill with 10" drill bit
- Tape measure
- 4' long straight edge or chalk line
- Sledge hammer
- Cold chisel
- Torpedo level
- String line
- Concrete & concrete tools

NOTE:

Use [HILTI RE-500-SD](#) adhesive anchor or [SIMPSON SET-XP](#) anchor adhesive or equivalent.

The AquaTram 90 Swimming Pool Access Lift should be installed in a deck or footing with the following specifications:

Your pool deck must be at least 4'-0" long by 4'-0" wide by 8" thick. It must be reinforced with 4 sticks of #5 rebar E-W, 2" clear (min) from the top and bottom of the footing and have a minimum concrete strength of 2500 PSI.

To ensure adequacy of an existing pool deck a 4'-0" square portion of the existing deck may be saw-cut, removed and replaced with a footing as specified above. The new slab reinforcing shall be drilled and epoxied into the existing slab as shown on page 6. If your deck or footing does not meet these requirements please call Pentair for recommendations. For decks that meet these requirements follow these instructions to install your anchor:

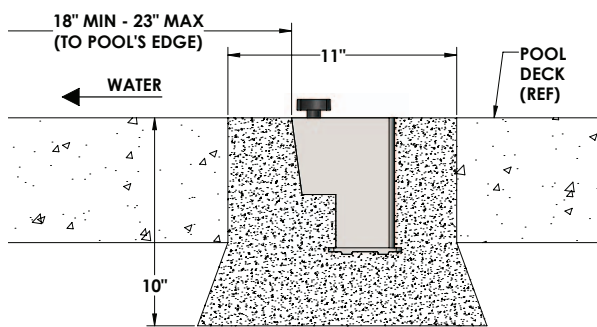

SIDE VIEW

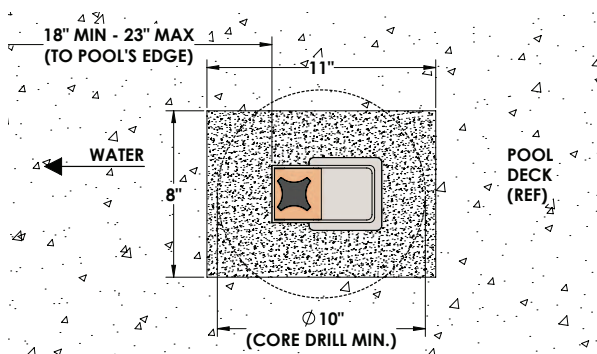

PLAN VIEW

1. Mark out a section of the pool deck to be removed using a chalk line or straight edge and a marker. Saw-cut an 11" x 8" section or core drill a 10" diameter hole. The finished hole should be 10" deep, with the front edge of the anchor no more than 23" from the pools edge.
2. Using the saw with the diamond blade, make cuts along the lines that were marked. Or, using the core drill rig, wet drill a 10" diameter hole.
3. Using the sledge hammer and chisel, break up the concrete within the area that was cut and remove the pieces.
4. After you have removed the portion of the deck, undercut the sides as shown in the top diagram to the left. Remove enough material until the hole is 10" deep as shown.
5. Set the anchor system in place making sure that the front edge of the anchor is no more than 23" away from the pools edge and that the knob is towards the pool as shown.
6. Using the string line or a straight edge, make sure the QS-ANCHOR is level and plumb with the finished deck surface.
7. Bond/ground the anchor system using the grounding lug on the anchor plate according to your local code requirements.

8. Stow the knob inside the anchor and put the cover on it.
9. Pour the concrete and finish the pool deck surface.

Anchor Installation: New Construction

For new construction a footing should be poured according to the diagram below. Make sure the anchor is installed flush and plumb with the deck surface. The footing should have the following specifications:

Your pool deck must be at least 4'-0" long by 4'-0" wide by 8" thick. It must be reinforced with 4 sticks of #5 rebar E-W, 2" clear (min) from the top and bottom of the footing and have a minimum concrete strength of 2500 PSI.

Obviously the deck may be larger than this - which is almost always the case when putting in a deck that surrounds the pool. Note that the entire deck does not need to be 8" thick, but that the area around the installed lift, 4'-0" by 4'-0", should be 8" thick at a minimum. The rest of the deck may be thinner - 4" is typical - as long as it is 8" thick around the lift.

The deck should be reinforced with 4 sticks of #5 rebar each way, 2" clear from the top and bottom of the footing. Our minimum requirement is that the 4'-0" by 4'-0" section be reinforced accordingly, but it is good practice to extend the rebar grid over the entire deck. Commonly, the rebar grid is used for grounding/bonding also. Bonding of the lift can usually be accomplished with a length of bare, 8AWG solid copper wire, connected to a piece of the rebar with an approved fitting and then connected to the grounding lug on the anchor plate. Note; this is only effective when the rebar grid itself has been bonded (attached to the pool's equipotential bonding grid with 8AWG solid copper wire). See NEC Article 680.26.

CHECK YOUR LOCAL ELECTRICAL CODE: BONDING REQUIREMENTS FOR POOL EQUIPMENT. ALWAYS BOND THE UNIT PER LOCAL ELECTRICAL CODES.

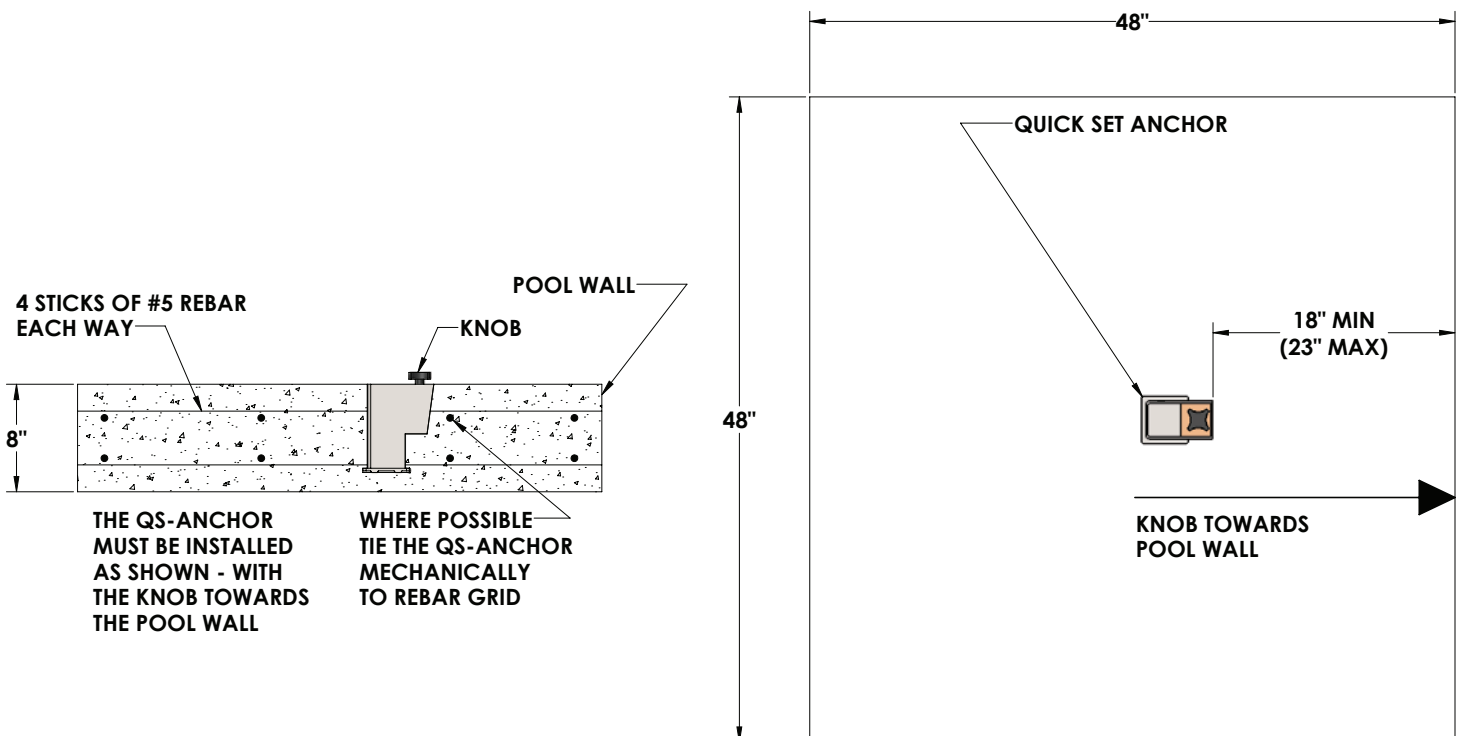

AquaTram Assembly Instructions

1. Attach seat belt to the seat as shown to the right.
2. Install the AquaTram pool lift into the anchor location on the concrete pad.
3. Before installing the battery, place it on the charging unit and let it charge for 24 hours. Make sure the orange "charge" light illuminates when the battery is being charged.
4. Remove the fully charged battery from the charger, grease the terminals, and install it on top of the control box. The battery will line up with the control box, and will 'click' when it properly locks in place. The lift will only operate when the battery is correctly mounted.

WHEN NOT IN USE, STORE THE BATTERY ON THE CHARGER!

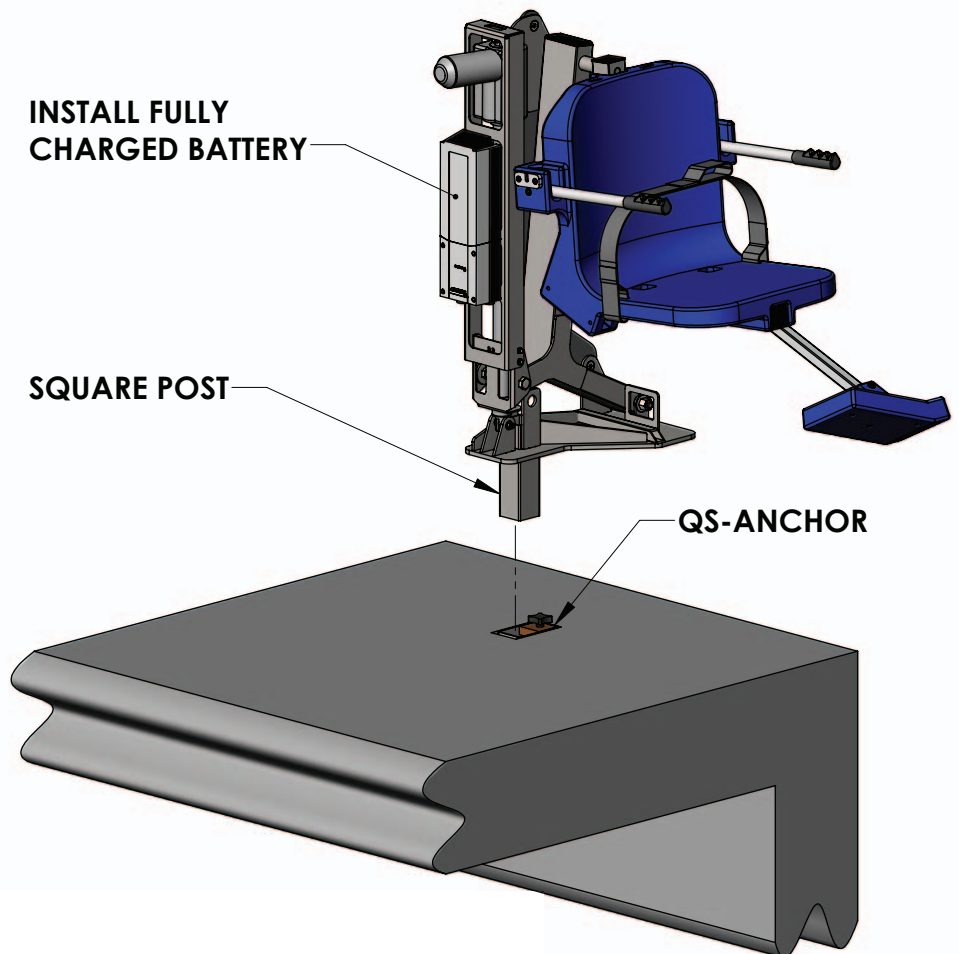

Basic Troubleshooting

Problem: The lift won't move.

Solution:

1. Make sure the battery is properly seated:

You should hear a click when the battery is properly seated on the control box or charger.

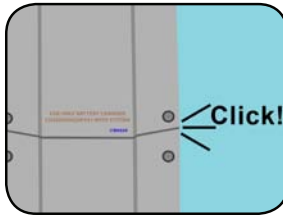

NOT Properly Attached:

Note: the white bracket is in front of the silver clip, which will not allow for an electrical connection



Properly Attached:

Note: the white bracket is behind the silver clip, holding it securely to allow for an electrical connection

2. Make sure the cords are properly plugged in:



NOT Properly Inserted:
The cord plug is flush with or sticking out of the outlet



Properly Inserted:
The cord plug is recessed into the outlet

Check the ends of the cords for corrosion or damage. The cord plugs should be recessed into the outlet. You should feel them pop into place when they are correctly inserted.

3. Check the contact points:



Make sure the contact points of the control box and the battery are not damaged or corroded. If there is corrosion clean with Scotch-Brite™ pad. Put some dielectric grease on the contact points before reattaching the battery.

4. Make sure the battery is fully charged:



The Charger is ON when the green light is glowing

The Battery is CHARGING when the orange light is glowing

When the Battery is charged the orange light will stop glowing

Problem: The lift stopped moving over the water and is stuck.

Solution:

1. Press the emergency button

Use a pen or pencil tip and stick it into the emergency button on the front of the control box to retract the lift.

Note: the lift will not retract if the battery is not fully charged or if the control box is not working. The emergency button only overrides the remote handset.



Proper Care of Pool & Spa Lifts

| PROCEDURE | DAILY | WEEKLY | MONTHLY |
|---|-------|--------|---------|
| Wash lift with fresh water and dry with clean, soft, non-abrasive cloth | ✓ | | |
| Recharge battery | ✓ | | |
| Run the lift through a complete test cycle to verify it is functioning properly | ✓ | | |
| Visually inspect lift for damage, corrosion, and loose or missing hardware | ✓ | | |
| Check all contact points for damage and/or corrosion | | ✓ | |
| Repair, clean and apply dielectric grease to all contact points | | ✓ | |
| Thoroughly clean lift frame and apply a liberal coat of car wax to maintain the lift's finish | | | ✓ |
| Check all Warning and Cautionary labels to make sure they are not faded or worn. Replace as needed. | | | ✓ |

PROPER CARE NOTES

- **Use only fresh water to wash your lift. Do not wash with pool water.**
- Use only clean, soft, non-abrasive cloths on your lift.
- Do not store lift in pump room or near chemicals.
- Do not allow children to play on or around this lift.
- When cleaning the lift, do not spray water directly on control box or battery.
- The lift may need to be bonded according to local code requirements.

STAIN REMOVAL TIPS:

To remove stubborn stains from finish, spray affected area with mild dish soap, rub briskly with a 3M Scotch Brite™ pad. Use white epoxy paint to touch up the finish. Apply wax to protect when dry.

For service and/or replacement parts, contact Pentair Water Pool and Spa, Inc.
Toll free: (800) 831-7133

AquaTram Parts List

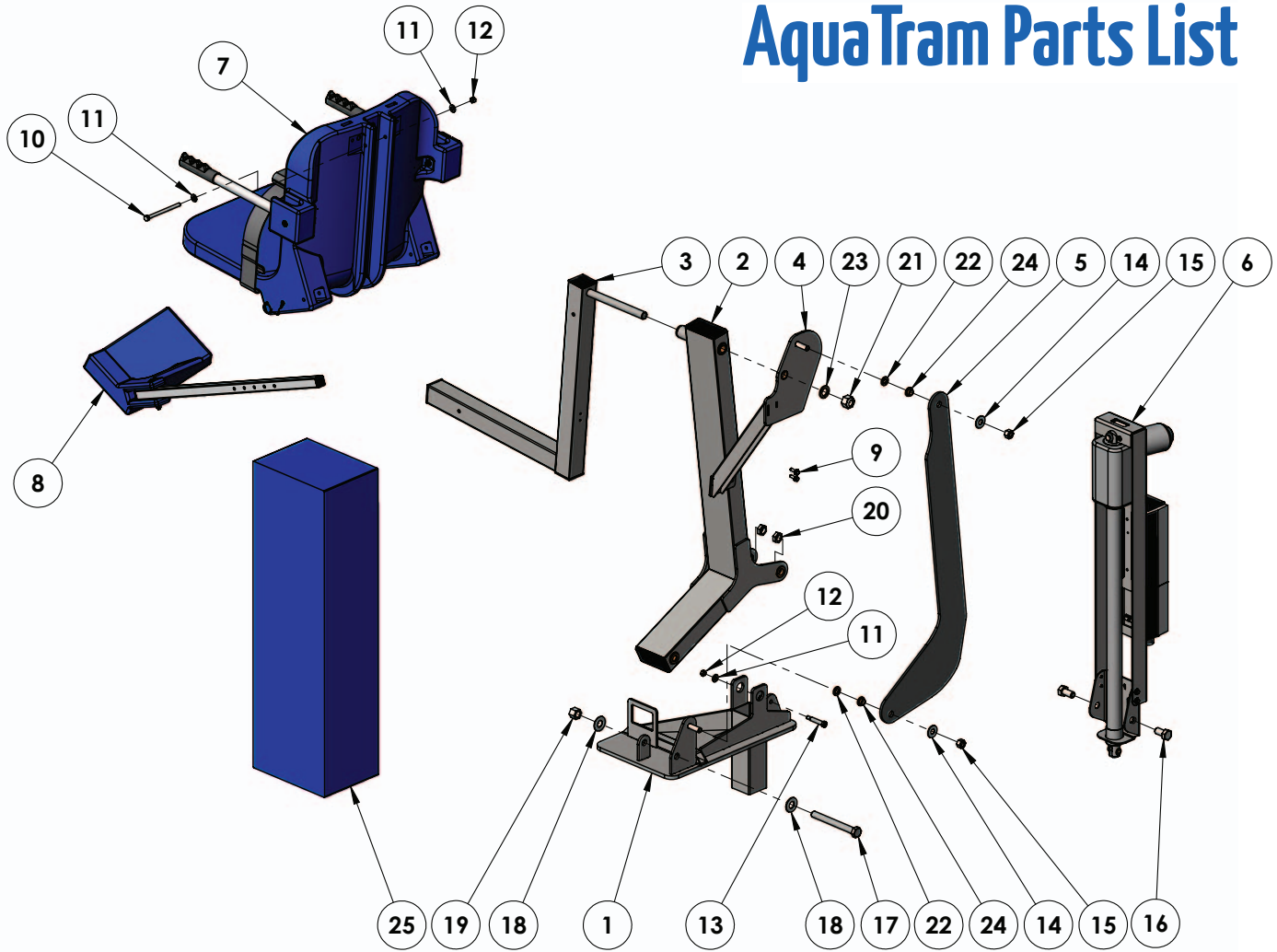

| ITEM # | QTY | PART # | DESCRIPTION |
|--------|-----|-------------------|----------------------------|
| 1 | 1 | A-0919PPL3-BPA-AT | AQUATRAM BASE ASSEMBLY |
| 2 | 1 | PPF-200-11 | MAIN FRAME ASSEMBLY |
| 3 | 1 | A-2012ARM-R1 | CHAIR ARM ASSEMBLY |
| 4 | 1 | A-2012SRS2 | SEAT SUPPORT ASSEMBLY |
| 5 | 1 | L-2014FBL-PAT-R2 | CONTROL ARM |
| 6 | 1 | UHF-PP-01 | ACTUATOR FRAME ASSEMBLY |
| 7 | 1 | SA-0904CA-A | CHAIR ASSEMBLY |
| 8 | 1 | F-0904FRA | FOOTREST ASSEMBLY |
| 9 | 2 | BHW 1/4 X 3/4 | 1/4 X 3/4" HEX WASHER HEAD |
| 10 | 1 | BH 5/16 X 4 1/2 | 5/16 X 4 1/2 HEX BOLT |
| 11 | 3 | WF 5/16 | 5/16 FLAT WASHER |
| 12 | 2 | NN 5/16 | 5/16 NYLOCK NUT |

| ITEM # | QTY | PART # | DESCRIPTION |
|--------|-----|----------------------------|---|
| 13 | 1 | BS 3/8 X 1 3/4 18-8 | 3/8 X 1 3/4 SHOULDER BOLT |
| 14 | 2 | WF 1/2 | 1/2 FLAT WASHER |
| 15 | 2 | NN 1/2 | 1/2 NYLOCK NUT |
| 16 | 2 | BH 5/8 X 1 1/4 | 5/8 X 1 1/4 HEX BOLT |
| 17 | 1 | BH 5/8 X 5 7/8 18-8 | 5/8 X 5 7/8 HEX BOLT |
| 18 | 2 | WF 5/8 | 5/8 FLAT WASHER |
| 19 | 1 | NN 5/8 | 5/8 NYLOCK NUT |
| 20 | 2 | NNJ 5/8 | 5/8 NYLOCK JAM NUT |
| 21 | 1 | NN 3/4 | 3/4 NYLOCK NUT |
| 22 | 2 | THRUST WASHER, 1/2, BRONZE | 1/2 BRONZE WASHER, TT-1001-1 |
| 23 | 1 | THRUST WASHER, 3/4, BRONZE | 3/4 BRONZE WASHER, TT-1205-1 |
| 24 | 2 | BRB FL-50-3 | 1/2 X 5/8 X 3/8 X 1/8 BRONZE FLANGE BUSHING |
| 25 | 1 | F-45ACB-C | ACTUATOR COVER |

Seat Assembly Parts List

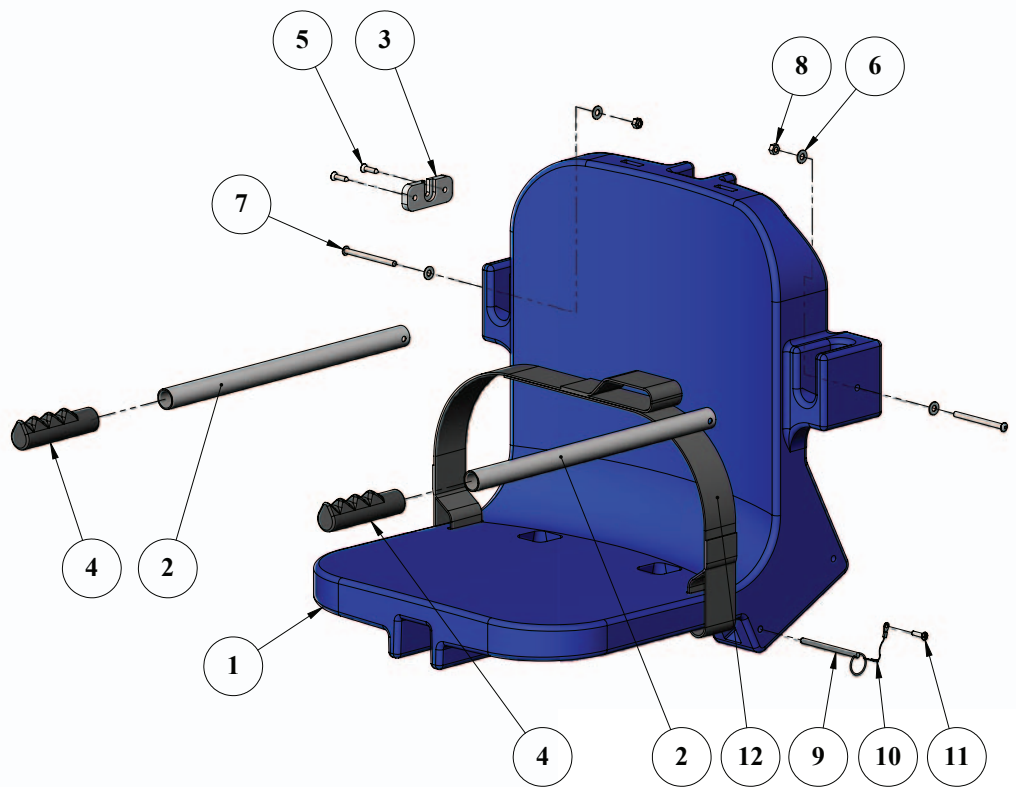

| ITEM # | QTY | PART # | DESCRIPTION |
|--------|-----|-------------------------|---|
| 1 | 1 | P-901 | CHAIR, PLASTIC, 18" BLUE |
| 2 | 2 | P-2100FLA-38 | CHAIR II ARMREST TUBE |
| 3 | 1 | P-1208HSB | BRACKET, PLASTIC, HANDSET BRACKET |
| 4 | 2 | RUBBER HAND GRIPS | GRIP, RUBBER HAND GRIPS |
| 5 | 2 | SFL 12 X 3/4 | SCREW, 316 SS, #12 X 3/4", FHSMs |
| 6 | 4 | WF 1/4 | WASHER, FLAT, 1/4, 316 SS |
| 7 | 2 | BB 1/4 X 3-1/4 | BOLT, 316 SS, 1/4-20 X 3 1/4 BHSCS |
| 8 | 2 | NN 1/4 | NUT, 316 SS, NYLOCK, 1/4"-20 |
| 9 | 1 | COTTER PIN, 1/4 X 3 1/4 | PIN, COTTERLESS PIN, 18-8 SS, 1/4 X 3 3/4 |
| 10 | 1 | LANYARD | LANYARD, FOR FOOTREST PIN, SS |
| 11 | 1 | SPH 10 X 3/4 | SCREW, 316 SS, #10 X 3/4", PHSMs |
| 12 | 1 | F-38SB | SEAT BELT, 2" BLACK W/ VELCRO |



AquaTram® Swimming Pool Lift FIVE (5) YEAR LIMITED WARRANTY

A Division of Pentair Water Pool and Spa, Inc.

AquaTRAM Lift has a **Limited FIVE-YEAR Warranty** on the frames, not including the powder coat finish.

Pentair Water Pool and Spa, Inc. ("Pentair") also warrants to the original end user purchaser that the AquaTRAM Lift ("Lift"), when properly installed in accordance with assembly and installation instructions, and properly used and maintained, shall be free from defects in material and workmanship for a period of five (5) years from the date of original purchase, provided that Pentair receives prompt notice in writing of any claim and satisfactory proof thereof.

This warranty specifically excludes reimbursement for labor to remove, repair, replace or install the Lift or component part thereof and any return freight charges.

These warranties do not cover any damages due to accident, misuse, abuse, negligence or failure to properly maintain any Lift or component part thereof, or normal wear and tear from day to day operations. In the event that any Lift or component part thereof are altered, repaired, or improperly installed or improperly used by anyone without the prior written approval by Pentair, all warranties are void. **IMPORTANT: AMOUNT OF WEIGHT PLACED ON LIFT SHALL NOT EXCEED THE RATED LIFT CAPACITY OF 400 POUNDS (181 KG).**

To initiate a warranty claim, the owner of an AquaTRAM Lift must provide the place of purchase, in writing, with a full description of the Lift, its serial number, the dates of purchase and installation, and the exact nature of the claim. Within thirty (30) days after receipt of a written warranty claim by Pentair, and barring any unforeseen delays, the place of purchase will be notified of Pentair's decision regarding the claim.

If requested by Pentair, any Lift or component part thereof must be returned, freight prepaid, to Pentair's designated factory location or duly appointed distributor for inspection and/or repair or replacement. Pentair will, at its option, refund the purchase price, or repair or replace the Lift or component part thereof, and deliver the repaired Lift or component part thereof or replacement to the buyer of the Lift, freight prepaid to the destination provided for in the original order. Lift or component part thereof returned to Pentair for which Pentair provides replacement under this limited warranty shall become the property of Pentair.

A new warranty period shall NOT be established for the repaired or replaced Lift or component part thereof. Such Lift or component part thereof shall remain under warranty only for the remainder of the original warranty period on the original Lift purchased.

This written limited warranty constitutes the final, complete and exclusive statement of warranty terms. No person or organization is authorized to make any other specific or implied warranties or representations on behalf of Pentair.

THE WARRANTIES SET FORTH HEREIN ARE IN LIEU OF ALL OTHER WARRANTIES, EXPRESSED OR IMPLIED, WHICH ARE HEREBY DISCLAIMED AND EXCLUDED, INCLUDING WITHOUT LIMITATION ANY WARRANTY OF MERCHANTABILITY OR FITNESS FOR A PARTICULAR PURPOSE OR USE.

THE SOLE AND EXCLUSIVE REMEDIES FOR BREACH OF ANY AND ALL WARRANTIES WITH RESPECT TO THE LIFT OR COMPONENT PART THEREOF SHALL BE LIMITED TO REPAIR OR REPLACEMENT AT PENTAIR'S DESIGNATED FACTORY LOCATION, OR DULY APPOINTED DISTRIBUTOR, OR SUCH OTHER PLACE AT PENTAIR'S SOLE OPTION. IN NO EVENT SHALL PENTAIR'S LIABILITY EXCEED THE ENTIRE AMOUNT PAID TO PENTAIR BY THE ORIGINAL PURCHASER FOR THE LIFT OR COMPONENT PART THEREOF.

IN NO EVENT SHALL PENTAIR BE LIABLE FOR ANY INCIDENTAL, CONSEQUENTIAL, SPECIAL, INDIRECT, PUNITIVE OR EXEMPLARY DAMAGES OR LOST PROFITS FROM ANY BREACH OF THIS LIMITED WARRANTY OR OTHERWISE.

Pentair Commercial Aquatics™, A Division of Pentair Water Pool and Spa, Inc.

1620 Hawkins Ave., Sanford, NC 27330
1351 Route 55, LaGrangeville, NY 12540
Phone: (800) 831-7133
Fax: (919) 566-8920
www.pentaircommercial.com



1620 HAWKINS AVE., SANFORD, NC 27330 • (919) 566-8000
10951 WEST LOS ANGELES AVE., MOORPARK, CA 93021 • (805) 553-5000

All Pentair trademarks and logos are owned by Pentair or one of its global affiliates. Pentair Commercial Aquatics™ and AquaTRAM® are trademarks and/or registered trademarks of Pentair Water Pool and Spa, Inc. and/or its affiliated companies in the United States and/or other countries. Unless expressly noted, names and brands of third parties that may be used in this document are not used to indicate an affiliation or endorsement between the owners of these names and brands and Pentair Water Pool and Spa, Inc. Those names and brands may be the trademarks or registered trademarks of those third parties. Because we are continuously improving our products and services, Pentair reserves the right to change specifications without prior notice. Pentair is an equal opportunity employer.

© 2017 Pentair Water Pool and Spa, Inc. All rights reserved.

P/N 11200 REV C 6/1/17