



REBEL®, WARRIOR® AND TUCSON®

CLEANER TUNE-UP KIT INSTALLATION GUIDE

Review and understand all important warning and safety instructions in the cleaner manual before performing the following procedures. The latest cleaner manual can be found at www.pentair.com.

REMOVING THE EXISTING DRIVE ASSEMBLY

1. Ensure the pool pump is off. Remove the cleaner from the pool and disconnect the cleaner from the leader hose.
2. Place the cleaner on a flat work surface.
3. Unlock the front buckle on the front of the cleaner.
4. Remove the top cover from the cleaner and set it aside.
5. Remove the turbine cover from the cleaner body and set it aside.
6. Remove the two 5mm hex screws from the wheel hubs.
7. Remove both wheel hubs and wheels from the cleaner.

LEFT DRIVE KIT (FIGURE 1A AND 2)

8. Gently pull the Drive Shaft (1) away from the cleaner.

Note: Use care when removing the Drive Shaft. Two Springs (2) are loaded into the Reversing Drive (3) and will release when removed from its compartment.

RIGHT DRIVE KIT (FIGURE 1B AND 3)

9. Remove the Drive Gear (3) from the Drive Shaft (4).
10. Remove the Drive Shaft (4) and Outside Bearing by pulling the Drive Shaft away from the cleaner.
11. The Inside Bearing (5) will remain inside its compartment. Press the bearing out with your thumb.

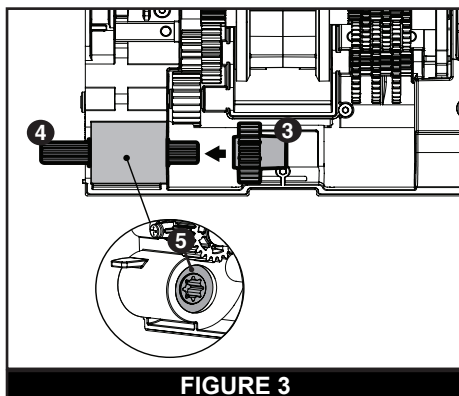
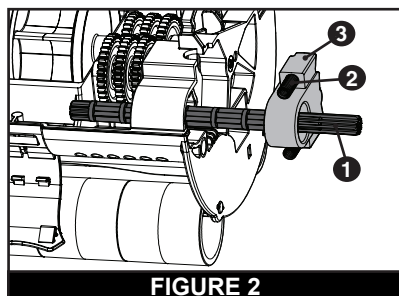
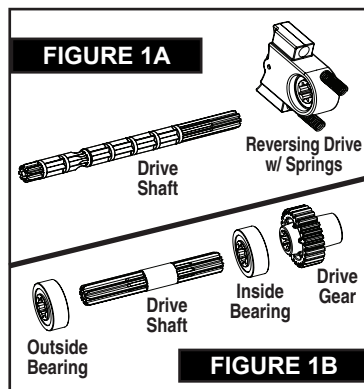

INSTALLING THE NEW DRIVE ASSEMBLY

RIGHT DRIVE KIT (FIGURE 3 AND 4)

1. Unpackage the new Right Drive Shaft and Bearings. Assemble as shown in **Figure 3**.
2. Ensuring the longer side of the Drive Shaft **(1)** is facing outwards, press the assembled Drive Shaft into the cleaner.
3. Install the Drive Gear **(2)** onto the Drive Shaft **(1)**.

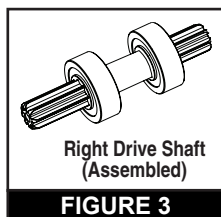

FIGURE 3

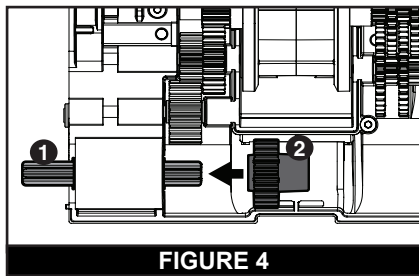

FIGURE 4

LEFT DRIVE KIT (FIGURE 5 AND 6)

4. Unpackage the new Left Drive Shaft and Reversing Drive. Assemble as shown in **Figure 5**.
5. Install the Drive Shaft **(3)** by pressing it into the Right Drive Gear **(4)**.
6. Install the two Springs **(5)** into the Reversing Drive **(6)**.
7. While compressing the two Springs **(5)**, install the Reversing Drive **(6)** into the cleaner.
8. Ensure wheel bearings are seated inside the new wheels. Slide the wheels onto the newly installed drive shafts.
9. Install the new wheels hubs onto the drive shafts
10. Secure the wheels and wheel hubs to the cleaner using the provided 5mm hex screws.
11. Reinstall the turbine cover.
12. Reinstall the top cover onto the cleaner and lock the front buckle.

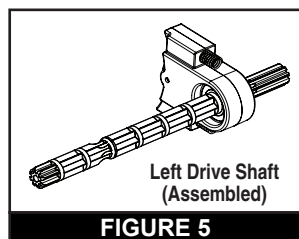

FIGURE 5

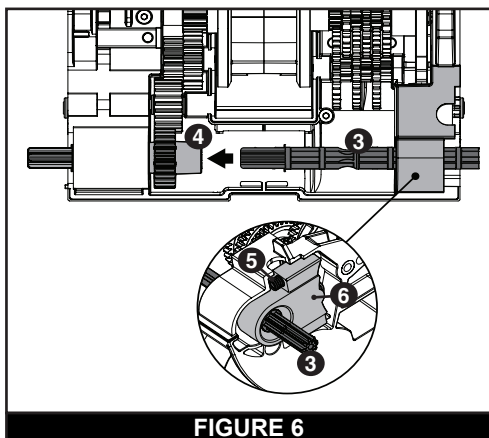

FIGURE 6



1620 HAWKINS AVE., SANFORD, NC 27330 • (919) 566-8000
10951 WEST LOS ANGELES AVE., MOORPARK, CA 93021 • (805) 553-5000
WWW.PENTAIR.COM

All indicated Pentair trademarks and logos are property of Pentair. Third party registered and unregistered trademarks and logos are the property of their respective owners. Because we are continuously improving our products and services, Pentair reserves the right to change specifications without prior notice. Pentair is an equal opportunity employer.

© 2020 Pentair. All rights reserved. This document is subject to change without notice.

P/N 372124 REV. A 11/18/20