

GLOBRITE® NICHE ADAPTER (P/N 618040) FOR MICROBRITE® LED LIGHTS

The GloBrite Niche Adapter allows installation of MicroBrite lights into existing GloBrite niches. Follow the instructions below to ensure proper installation.

INSTALLING LIGHT INTO NICHE ADAPTER

1. Remove the *Threaded Adapter* (1) from the MicroBrite light.
2. Route the power cord through the *Niche Adapter* (2).
3. Stretch *O-ring* (3) over lens and seat in proper position.
4. Using the provided lubricant, lubricate the *O-ring* (3).
5. Align the three *Locking Tabs* (4) on the MicroBrite light with three *Locking Notches* (5) on the *Niche Adapter* (2).
6. Gently push the MicroBrite into the *Niche Adapter* (2) until the three *Locking Tabs* (4) click into the adapter.

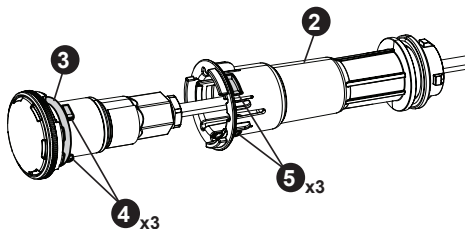
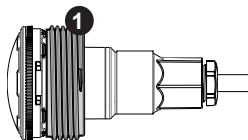

INSTALLING ADAPTER INTO NICHE

1. Route the light power cord through the niche and to the 12 VAC transformer or junction box.
2. At the transformer or junction box, leave at least 6 in. [15.2 cm] of cord in the junction box or transformer. Remove additional cord as needed.
3. Ensure the inside of the *Niche* (6) is clean.
4. Push the light into the *Niche* (6), making sure the four *Locking Tabs* (7) at the end of the adapter engage with the niche.
5. Place the *Installation Tool* (8) over the front of the light.
6. While pushing inward, turn the *Installation Tool* (8) clockwise 1/8th turn, until a stop point is reached. The light should now be properly locked into the niche.



CAUTION HAND-TIGHTEN ONLY. OVERTIGHTENING CAN PERMANENTLY DAMAGE THE LIGHT.

7. Ensure the light cannot be unscrewed by hand.

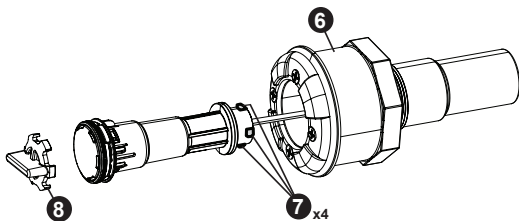

All indicated Pentair trademarks and logos are property of Pentair. Third party registered and unregistered trademarks and logos are the property of their respective owners.

© 2025 Pentair. All rights reserved. WWW.PENTAIR.COM



P/N 619157 REV. A 3/13/25