

SYSTEM:2™ MODULAR MEDIA FILTERS

PLM SERIES REPLACEMENT PARTS



MODELS

PLM100

PLM125

PLM150

PLM175

PLM200

PLM300

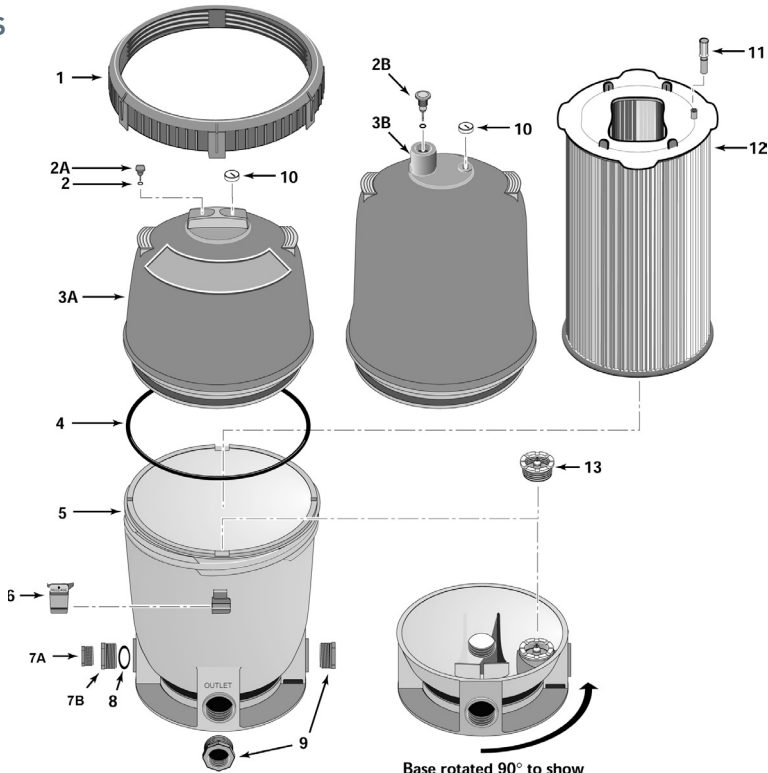

Base rotated 90° to show check valve installed.

Item	Part No.	Description
SYSTEM:2 MODULAR MEDIA FILTERS		
1	27001-0054S	Posi-Lok™ ring
2	U9-359	O-ring
2A	25010-0200	Air release valve assy. w/ O-ring P/N U9-359
2B	24206-0103S	Air vent stem w/ O-ring P/N 35505-7439
3A	27001-0020S	Tank shell upper half ^{1,5} Models PLM100, PLM125, PLM150, PLM175, PLM200
3B	27001-0030S	Tank shell upper half ^{1,5} Model PLM300
4	27001-0061S	Cord-ring
4	27001-0060S	Cord-ring (Pre 3/97) Models PLM100, PLM150
5	27001-0009S	Tank shell lower half ^{4,5}
6	27001-0051	Safety latch for ring
7A	27001-0022	1-1/2 in. NPT plug
7B	24900-0510	Adapter fitting

Item	Part No.	Description
8	35505-1424	O-ring
9	U78-820P	2 in. x 1-1/2 in. Pipe reducer ²
10	15060-0000T	Pressure gauge ³
11	24800-0121	Air bleed assembly
12	27002-0100S	Filter module - Model PLM100
12	27002-0125S	Filter module - Model PLM125
12	27002-0150S	Filter module - Model PLM150
12	27002-0175S	Filter module - Model PLM175
12	27002-0200S	Filter module - Model PLM200
12	27002-0300S	Filter module - Model PLM300
13	27001-0130S	Spring check valve ²
NOT SHOWN		
	33455-1050	Spring check valve gasket

¹ Includes all decals and labels.

² Optional Equipment.

³ Shipped in accessory package.

⁴ Includes 24900-0510 adapter fitting, 27001-0051 safety latch, & 27001-0054 PosiLok™ ring.

⁵ Filters manufactured before 2005 should also purchase a top and bottom.