

# INTELLICENTER® CONTROL SYSTEM

## BATTERY REPLACEMENT KIT INSTRUCTIONS FOR WIRELESS REMOTE (P/N 522054)

### Battery Removal

1. **TURN OFF POWER TO THE WIRELESS REMOTE: SETTINGS > TURN OFF WIRELESS REMOTE.**
2. Place the Wireless Remote face down on a clean flat surface.
3. Remove the eight (8) retaining screws from the back cover.
4. Carefully remove the back cover with the gasket. Discard the gasket.
5. Press the tab on the battery wire connector and pull upward to release the connector from the circuit board.
6. Remove the battery from the unit.

### Battery Installation

1. Insert and press the battery wire connector until seated in the circuit board socket.
2. Place the battery in the unit.
3. Insert the gasket in the inside of the back cover grooves. Be sure the gasket is seated correctly in the grooves.
4. Secure the back cover with the eight (8) retaining screws.
5. Tap the LCD screen to turn on power to the Wireless Remote.

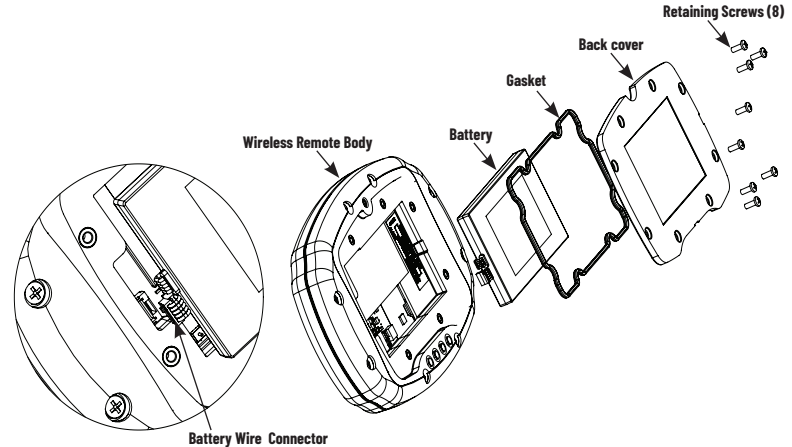

**IMPORTANT! LITHIUM BATTERY DISPOSAL: Please dispose of the Wireless Remote lithium battery at your local battery recycling facility as required by your local and state regulation. DO NOT dispose of the lithium battery in your garbage or recycling containers.**